

REV	REVISION DETAILS	ECO	DATE	BY	ABY
0	INITIAL RELEASE	NP-2156	10-17-2019	JWK	JJW

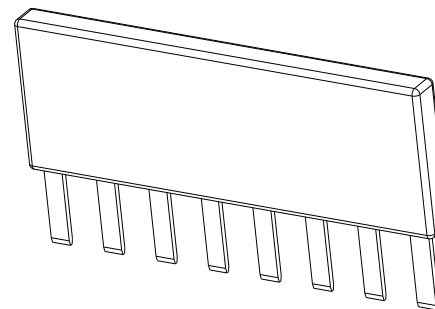

ISO VIEW  
FOR REF ONLY

### CONFIDENTIAL

The information contained in this document is the property of GEP Power Products. It is not for public disclosure. Possession of the information does not convey any right to loan, sell or disclose the information. Unauthorized reproduction or use of the information is prohibited. This document is to be returned to GEP Power Products upon completion of the purpose for which it is loaned or upon request.



CRITICAL DIMENSIONS ON FEATURES TO BE CHECKED DURING ANY SET-UP ADJUSTMENTS, TOOL CHANGES, OR ANNUAL MAINTENANCE ON TOOLING.



DIMENSIONS OR FEATURES TO BE CHECKED FROM RUN-TO-RUN

TOLERANCES UNLESS  
OTHERWISE SPECIFIED

THIRD ANGLE PROJECTION



METRIC TOL

ENGLISH TOL

ANGULAR TOL =  $\pm 2^\circ$   
FRACTION TOL =  $\pm 1/64$  IN

1 PL DEC. =  $\pm .25$   
2 PL DEC. =  $\pm .13$

2 PL DEC. =  $\pm .01$   
3 PL DEC. =  $\pm .005$

DIMENSIONS INSIDE PARENTHESES  
OR CONTAINING "REF" ARE FOR  
REFERENCE ONLY.

COPYRIGHT - GEP POWER PRODUCTS

This is unpublished work. The disclosure of this work is limited to a select personnel. Further dissemination or disclosure to the public is PROHIBITED. This unpublished work is protected by Federal Copyright law and all rights thereunder are reserved by GEP Power Products.

		16830 Pheasant Drive Brookfield, WI 53005			
PART NO:		SC30-2006A-B008 (SALES)			
DESCRIPTION:		BUSBAR - PDM, 8 POS, STRAIGHT, INSULATED			
CUSTOMER:		STANDARD			
ENGLISH (IN)	REV	SHEET	SCALE	SIZE	
	0	1 OF 2	1:1	A	

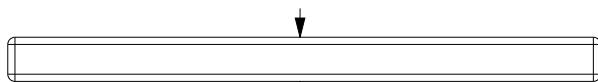

(0.184)

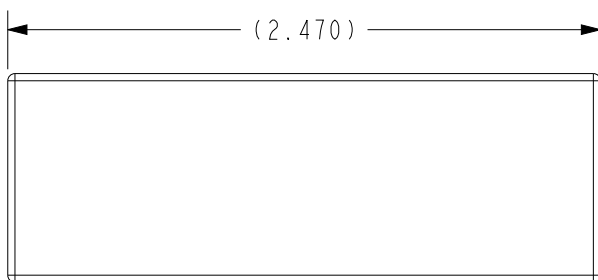

(2.470)

(0.110) TYP

(0.210) TYP

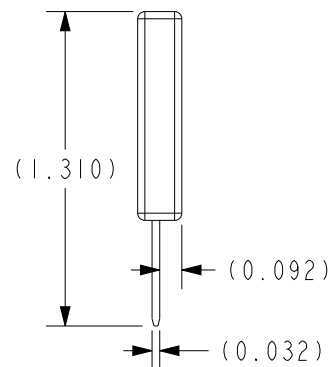

(1.310)

(0.092)

(0.032)

NOTES:

1. MATERIAL: OVER-MOLD - PVC  
BUSBAR - TIN PLATED COPPER
2. COLOR: RED
3. DO NOT EXCEED MATING TERMINAL AMP RATING AT ANY SINGLE CONNECTION POINT
4. DO NOT EXCEED 60 AMPS TOTAL THROUGH BUSBAR



16830 Pheasant Drive  
Brookfield, WI 53005

PART NO: SC30-2006A-B008 (SALES)

DESCRIPTION: BUSBAR - PDM, 8 POS, STRAIGHT,  
INSULATED

CUSTOMER: STANDARD

ENGLISH (IN)	REV	SHEET	SCALE	SIZE
	0	2 OF 2	1.25:1	A