

PTSR-X

OPTIONS

- A - CONNECTOR & SEAL ASSEMBLY
- T - TPA (TERMINAL POSITION ASSURANCE)

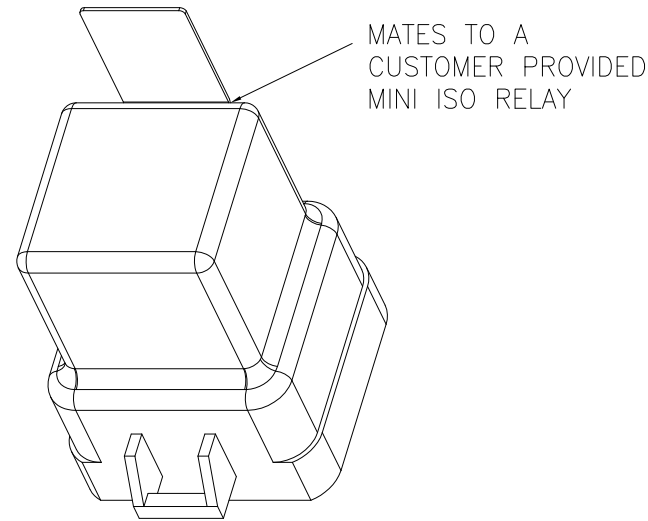
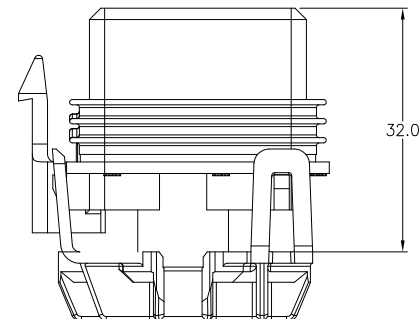
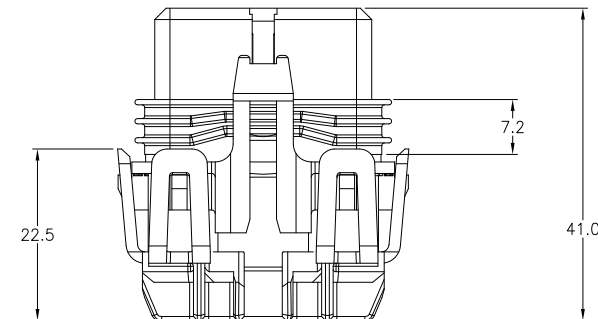
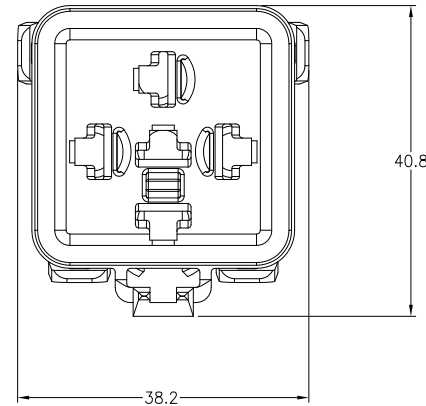

CAVITY ID

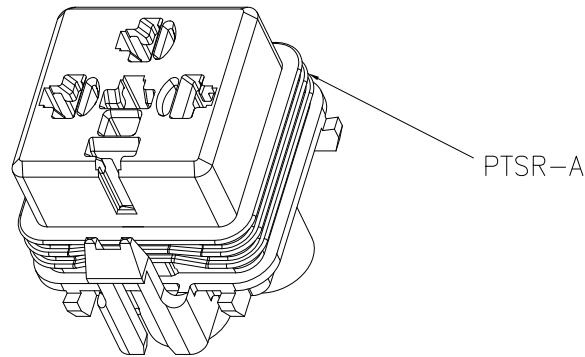
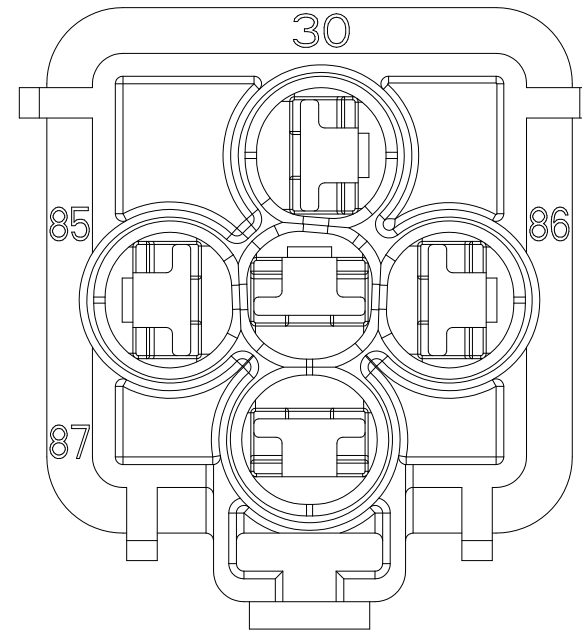

PTSR-A

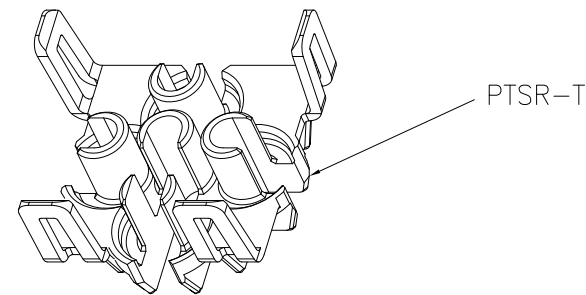

PTSR-T

PART NO. PTSR-X (SALES)		TITLE PUSH-TO-SEAT RELAY HOLDER	
CUSTOMER STANDARD		SCALE 1:1	
REV #	REVISION	DATE	BY APPROVE
0	RELEASED FOR PRODUCTION	01-02 2017	SL RR

DELPHI 630 METRI-PACK TERMINALS

PART #	CABLE AWG RANGE	CABLE AREA RANGE (mm <sup>2</sup> )	MATERIAL	PLATING
15317331	10	4.00-6.00	BRASS	TIN
12052456	12 - 10	3.00-5.00	BRASS	TIN
12052455	16 - 14	1.00-2.00	BRASS	TIN
12052457	20 - 18	0.50-0.80	BRASS	TIN
15317332	10	4.00-6.00	COPPER	SILVER
15305232	12 - 10	3.00-5.00	COPPER	SILVER

DELPHI 480 METRI-PACK CABLE SEALS

PART #	TYP. AWG	CABLE DIAMETER (mm)	MATERIAL	COLOR
12162067	20 AWG	1.29-1.70	SILICONE	PINK
15324991	18 AWG	1.60-2.15	SILICONE	YELLOW
15324988	16 AWG	2.01-2.85	SILICONE	WHITE
15324989	14 AWG	2.81-3.76	SILICONE	RED
15324990	12 AWG	3.61-4.50	SILICONE	PURPLE
15324987	10 AWG	4.40-5.16	SILICONE	ORANGE
12066082	N/A	PLUG	SILICONE	LT. GREEN

NOTES:

1. CONNECTOR MATERIAL: UNFILLED PBT
2. TPA MATERIAL: UNFILLED NYLON
3. SEAL MATERIAL: SILICONE
4. DESIGNED TO USE DELPHI 630 METRI-PACK TERMINALS WITH 480 METRI-PACK SEALS -SEE TABLE
5. USE OF SILVER PLATED TERMINALS IS RECOMENDED FOR POWER POSITIONS
6. DIMENSIONS ARE FOR REFERENCE ONLY
7. CRIMPING TOOLS FOR AN AMP PRESS; BASE - 15433660 MODULE - 12156350 (CONSULT DELPHI)



CONFIDENTIAL - The information contained in this document is the property of GEP Power Products. It is not for public disclosure. Possession of the information does not convey any right to loan, sell or disclose the information. Unauthorized reproduction or use of the information is prohibited. This document is to be returned to GEP Power Products upon completion of the purpose for which it is loaned or upon request.

COPYRIGHT - GEP Power Products This is an unpublished work. The disclosure of this work is limited to a select personnel. Further dissemination or disclosure to the public is PROHIBITED. This unpublished work is protected by Federal Copyright law and all rights thereunder are reserved by GEP Power Products.

TOLERANCES UNLESS OTHERWISE SPECIFIED	
METRIC TOL	ENGLISH TOL
1 PL DEC.=±.25	2 PL DEC.=±.01
2 PL DEC.=±.13	3 PL DEC.=±.005

THIRD ANGLE PROJECTION  
ANGULAR TOL=±2°  
FRACTION TOL=±1/16 IN  
Measuring Typical Dims.:  
2-4 ALL  
5-8 50%  
9-20 25%

SPECIAL REQUIREMENTS:  
CRITICAL DIMENSIONS OR FEATURES TO BE CHECKED DURING ANY SET-UP ADJUSTMENTS, TOOL CHANGES, OR ANNUAL MAINTENANCE ON TOOLING.  
CRITICAL DIMENSIONS OR FEATURES TO BE CHECKED FROM RUN TO RUN  
○ FLAG NOTE CALLOUT