

REV	REVISION DETAILS	ECO	DATE	BY	ABY
0	INITIAL RELEASE	NP-006937	07-01-2025	JWK	JML

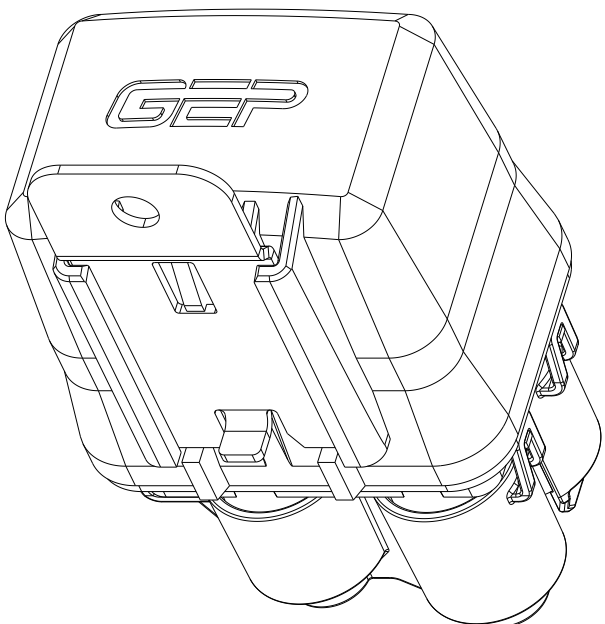

ISO VIEW  
FOR REF ONLY

**CONFIDENTIAL**

The information contained in this document is the property of GEP Power Products. It is not for public disclosure. Possession of the information does not convey any right to loan, sell or disclose the information. Unauthorized reproduction or use of the information is prohibited. This document is to be returned to GEP Power Products upon completion of the purpose for which it is loaned or upon request.

CRITICAL DIMENSIONS ON FEATURES TO BE CHECKED DURING ANY SET-UP ADJUSTMENTS, TOOL CHANGES, OR ANNUAL MAINTENANCE ON TOOLING.	DIMENSIONS OR FEATURES TO BE CHECKED FROM RUN-TO-RUN
TOLERANCES UNLESS OTHERWISE SPECIFIED	
THIRD ANGLE PROJECTION 	
METRIC TOL	ENGLISH TOL
1 PL DEC. = ±.25 2 PL DEC. = ±.13	2 PL DEC. = ±.01 3 PL DEC. = ±.005
ANGULAR TOL = ±2° FRACTION TOL = ±1/64 IN	
DIMENSIONS INSIDE PARENTHESES OR CONTAINING "REF" ARE FOR REFERENCE ONLY.	

COPYRIGHT - GEP POWER PRODUCTS  
This is unpublished work. The disclosure of this work is limited to a select personnel. Further dissemination or disclosure to the public is PROHIBITED. This unpublished work is protected by Federal Copyright law and all rights thereunder are reserved by GEP Power Products.

		16830 Pheasant Drive Brookfield, WI 53005		
PART NO:	FRH - MAXI ISO RELAY & MAXI FUSE SERIES (SALES)			
DESCRIPTION:	FRH - MAXI ISO RELAY AND MAXI FUSE SERIES DRAWING			
CUSTOMER:	STANDARD			
METRIC (MM)	REV	SHEET	SCALE	SIZE
	0	1 OF 8	1:1	B

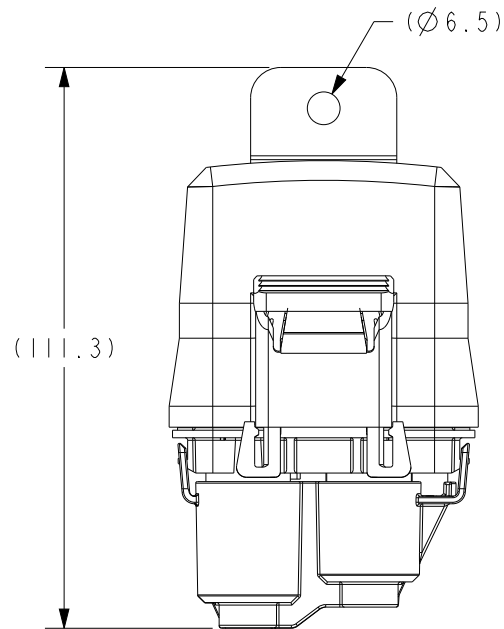
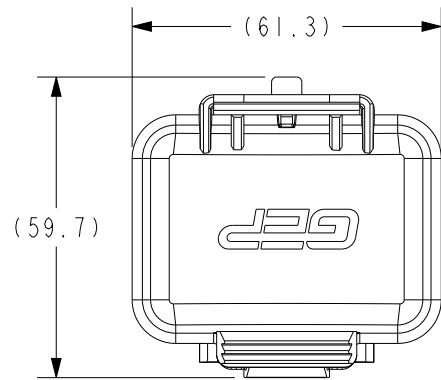

EXAMPLE CONFIGURATION WITH DIMENSIONAL INFO

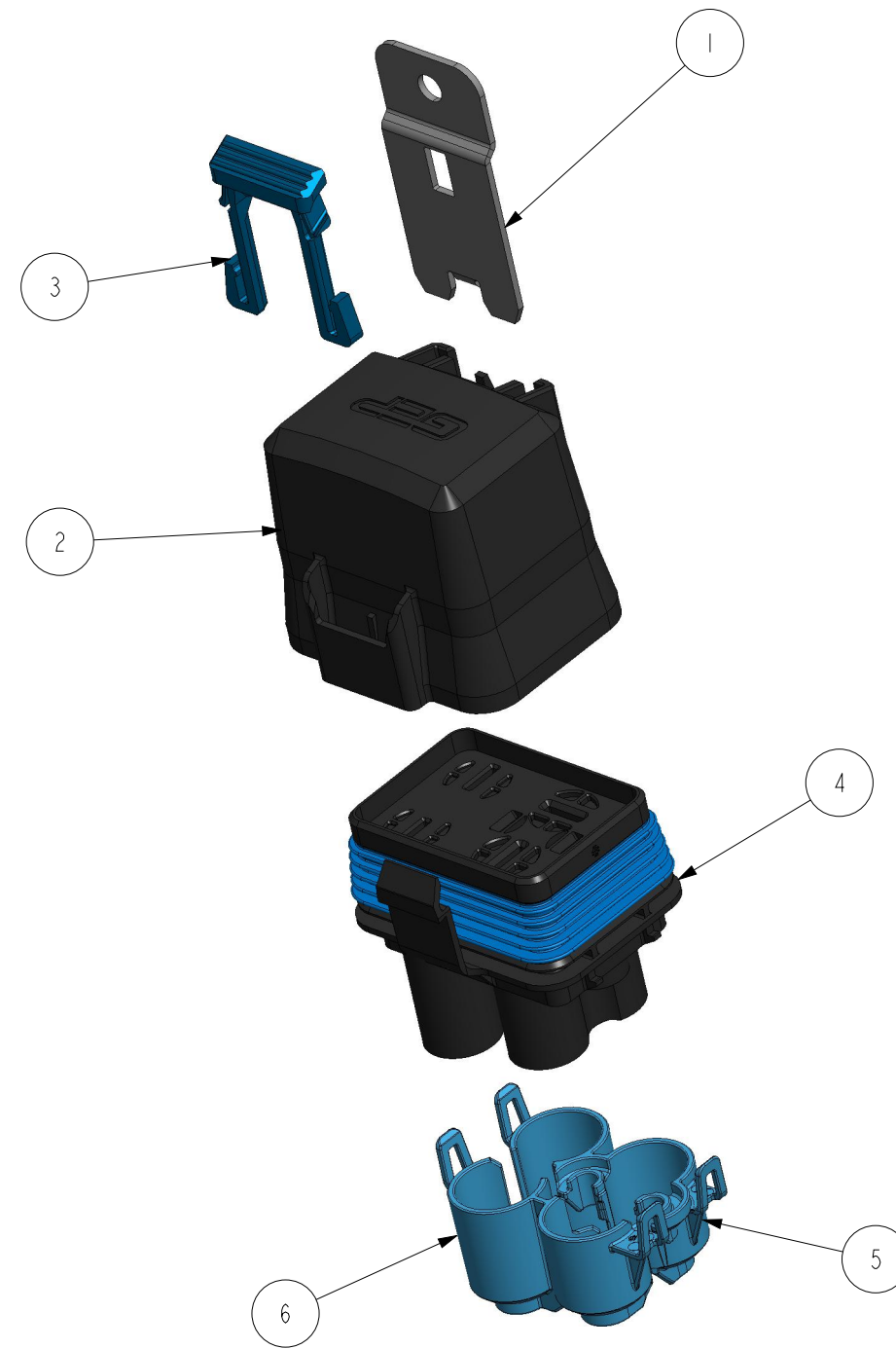

EXAMPLE CONFIGURATION EXPLODE VIEW

NOTES:

1. HOUSING, COVER & CPA MATERIAL: UNFILLED PBT
2. TPA MATERIAL: NYLON
3. BRACKET MATERIAL: ZINC PLATED STEEL OR STAINLESS STEEL
4. DESIGNED TO USE LEAR MAK8 TERMINALS WITH GEP SEALS, DELPHI 630 TERMINALS AND CABLE SEALS, LITTELFUSE MINI & MAXI FUSES (SEE TABLES C, D & E)
5. MOUNTING HOLE TO ANTI-ROTATION TAB DIM
6. RoHS AND REACH COMPLIANT

EXAMPLE CONFIGURATION BOM

ITEM	DESCRIPTION	PART NO.	QTY
1	BRACKET - PDM - FRH - FLAT WITH ANTI-ROTATION - ZINC STEEL	FRH-A12-MB-A1	1
2	COVER - PDM, FRH 24 POS	FRH-A24-C	1
3	CPA - PDM - FRH	FRH-A-CPA	1
4	HOUSING AND SEAL - FRH - MAXI ISO RELAY AND MAXI FUSE - 32V	SC42-2026A-A001	1
5	TPA - FRH - MAXI ISO RELAY AND MAXI FUSE - A SIDE	SC38-2015A-B003	1
6	TPA - FRH - MAXI ISO RELAY AND MAXI FUSE - B SIDE	SC38-2015B-B003	1

<b>GEP</b> POWER PRODUCTS		16830 Pheasant Drive Brookfield, WI 53005		
PART NO:	FRH - MAXI ISO RELAY & MAXI FUSE SERIES (SALES)			
DESCRIPTION:	FRH - MAXI ISO RELAY AND MAXI FUSE SERIES DRAWING			
CUSTOMER:	STANDARD			
METRIC (MM)	REV 0	SHEET 2 OF 8	SCALE 1:1.5	SIZE B

# HOUSING W/SEAL OPTIONS

SC42-2026A-A001  
 HOUSING AND SEAL - FRH -  
 MAXI ISO RELAY AND MAXI FUSE - 32V

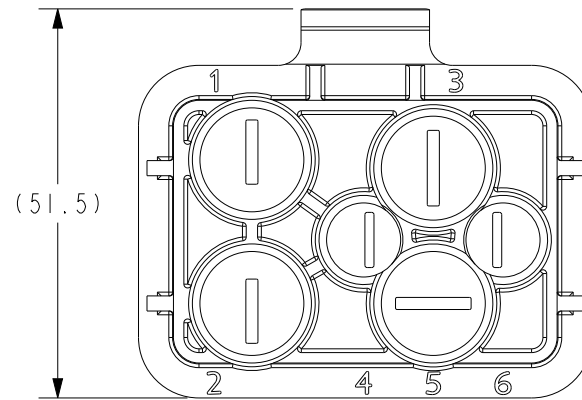
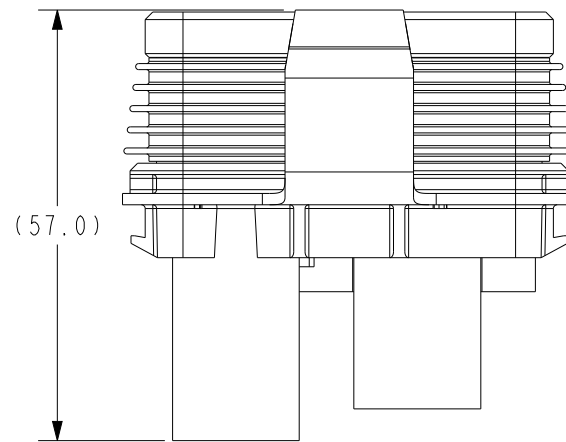
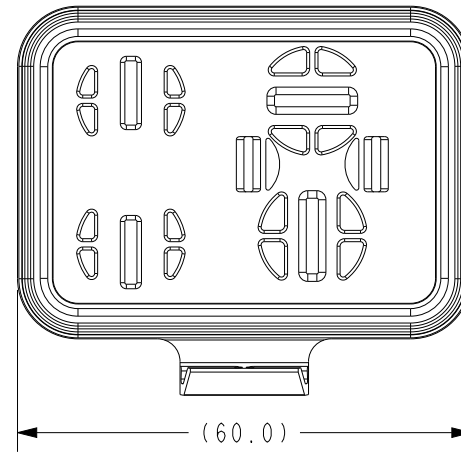

		16830 Pheasant Drive Brookfield, WI 53005		
PART NO:		FRH - MAXI ISO RELAY & MAXI FUSE SERIES (SALES)		
DESCRIPTION:		FRH - MAXI ISO RELAY AND MAXI FUSE SERIES DRAWING		
CUSTOMER:		STANDARD		
METRIC (MM)	REV	SHEET	SCALE	SIZE
	0	3 OF 8	1:1	B

# HOUSING TERMINALS AND SEALS

SC42-2026A-A001  
HOUSING AND SEAL - FRH -  
MAXI ISO RELAY AND MAXI FUSE - 32V

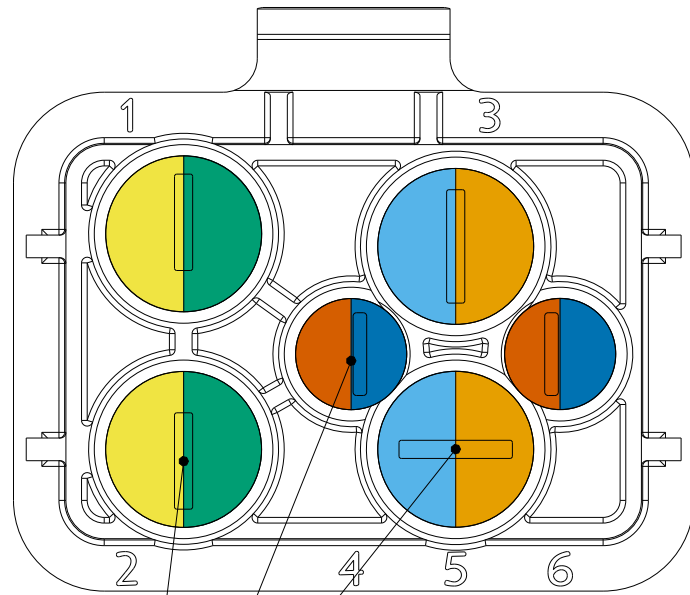

LEAR MAK8 CAVITIES  
SEE TABLE D FOR TERMINALS  
AND CABLE SEALS

DUCON 9.5 CAVITIES  
SEE TABLE E FOR TERMINALS  
AND CABLE SEALS

630 CAVITIES  
SEE TABLE C FOR TERMINALS  
AND CABLE SEALS

Table C				REV 0
DELPHI 630 METRI-PACK TERMINALS (FOR REF. ONLY)				
PART #	RANGE (mm <sup>2</sup> )	MATERIAL	PLATING	
15317331	4.00-6.00	TIN BRASS	TIN	
12052456	3.00-5.00	TIN BRASS	TIN	
12052455	1.00-2.00	TIN BRASS	TIN	
12052457	0.50-0.80	TIN BRASS	TIN	
15317332	4.00-6.00	BERYLLIUM COPPER	SILVER/NICKEL	
15305232	3.00-5.00	BERYLLIUM COPPER	SILVER/NICKEL	
DELPHI 630 METRI-PACK CABLE SEALS (FOR REF. ONLY)				
PART # REEL	PART # LOOSE	CABLE DIA.	MATERIAL	COLOR
10730240	15324997	1.65-2.15	SILICONE	TAN
15344951	15324995	2.01-2.85	SILICONE	DK. RED
10730241	15324994	2.81-3.75	SILICONE	GRAY
15344032	15324996	3.61-4.50	SILICONE	BLUE
	15324993	4.40-5.10	SILICONE	GREEN
12077760	12077759	1.65-2.15	SILICONE	TAN
12059259	12052388	2.01-2.85	SILICONE	DK. RED
12059258	12052387	2.81-3.75	SILICONE	GRAY
12059260	12052668	3.61-4.50	SILICONE	BLUE
12059257	12052386	4.40-5.10	SILICONE	GREEN
	12059255	PLUG	SILICONE	LT. GREEN
DELPHI 630 METRI-PACK TERMINAL REMOVAL TOOL (FOR REF. ONLY)				
PART # 12094430				

Table E				REV 0
DELPHI 9.5 DUCON TERMINALS				
PART #	CABLE RANGE (mm <sup>2</sup> )	MATERIAL	PLATING	
15327010	4.0-6.0	COPPER ALLOY	TIN	
15482568	4.0-6.0	COPPER ALLOY	SILVER/TIN	
10730408	10	COPPER ALLOY	TIN	
15408423	10	COPPER ALLOY	SILVER/TIN	
15458196	16	COPPER ALLOY	TIN	
15458198	16	COPPER ALLOY	SILVER/TIN	
DELPHI 9.5 DUCON CABLE SEALS (FOR REF. ONLY)				
PART #	CABLE DIA.	MATERIAL	COLOR	
15492996	2.20-3.00	SILICONE	BLUE	
15327126	3.4-4.3	SILICONE	DK. RED	
10720983	6.00-6.40	SILICONE	GREEN	
15470809	6.50-7.75	SILICONE	RED	
10720907	PLUG	SILICONE	GREEN	
GEP CABLE SEALS - 9.5 DUCON (FOR REF. ONLY)				
PART #	CABLE DIA.	MATERIAL	COLOR	
PDM-TWS-D4	4.6-5.3	SILICONE	LIGHT BLUE	
DELPHI 9.5 DUCON TERMINAL REMOVAL TOOL (FOR REF. ONLY)				
PART # 10714800				

Table D				REV 1
LEAR MAK8 PLUS TERMINALS (FOR REF. ONLY)				
PART NUMBER	RANGE (mm <sup>2</sup> )	PLATING	VARIATION	
28224 306 710	2.5-4.0	SILVER	1 - LONG SEAL	
28469 306 189	2.5-4.0	SILVER/TIN	3 - SHORT SEAL	
28225 306 710	6.0-10.0	SILVER	1 - LONG SEAL	
28459 306 189	6.0-10.0	SILVER/TIN	3 - SHORT SEAL	
28243 306 710	10.0-16.0	SILVER	1 - LONG SEAL	
GEP CABLE SEALS (VARIATION 1 - LONG)				
PART NUMBER	CABLE DIA.	MATERIAL	COLOR	
PDM-TWS-L1	2.7-3.0	SILICONE	GREEN	
PDM-TWS-L2	3.4-3.8	SILICONE	PURPLE	
PDM-TWS-L3	4.0-4.5	SILICONE	ORANGE	
PDM-TWS-L4	4.6-5.3	SILICONE	LIGHT BLUE	
PDM-TWS-L5	5.8-6.6	SILICONE	GRAY	
PDM-TWS-L6	6.5-7.8	SILICONE	RED	
GEP CABLE SEALS (VARIATION 3 - SHORT)				
PART NUMBER	CABLE DIA.	MATERIAL	COLOR	
PDM-TWS-S1	2.7-3.0	SILICONE	GREEN	
PDM-TWS-S2	3.4-3.8	SILICONE	PURPLE	
PDM-TWS-S3	4.0-4.5	SILICONE	ORANGE	
PDM-TWS-S4	4.6-5.3	SILICONE	LIGHT BLUE	
PDM-TWS-S5	5.8-6.6	SILICONE	GRAY	
GEP CABLE SEAL PLUG				
PDM-TWS-P	N.A.	SILICONE	YELLOW	
LEAR MAK8 PLUS TERMINAL REMOVAL TOOL (FOR REF. ONLY)				
PART # 50000017609 BY Karl Püpplichhuisen GmbH & Co.				

**GEP POWER PRODUCTS** 16830 Pheasant Drive  
Brookfield, WI 53005

PART NO: FRH - MAXI ISO RELAY & MAXI FUSE SERIES (SALES)

DESCRIPTION: FRH - MAXI ISO RELAY AND MAXI FUSE SERIES DRAWING

CUSTOMER: STANDARD

METRIC (MM)	REV 0	SHEET 4 OF 8	SCALE 1:1	SIZE B
-------------	-------	--------------	-----------	--------

# COVER OPTIONS

FRH-A24-C  
COVER - PDM, FRH 24 POS

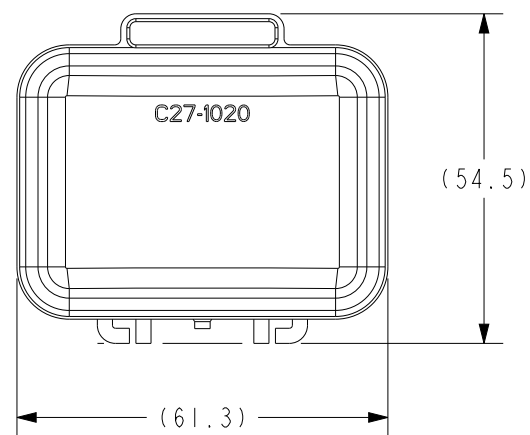
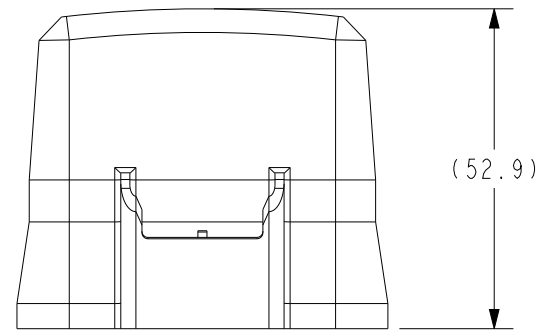
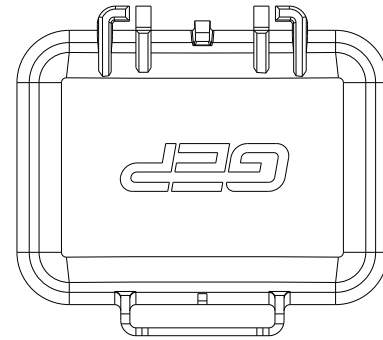

SC42-2028A-A001  
COVER WITH VENT - FRH - A24

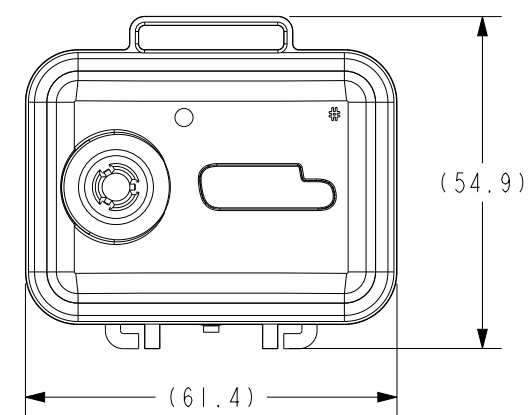
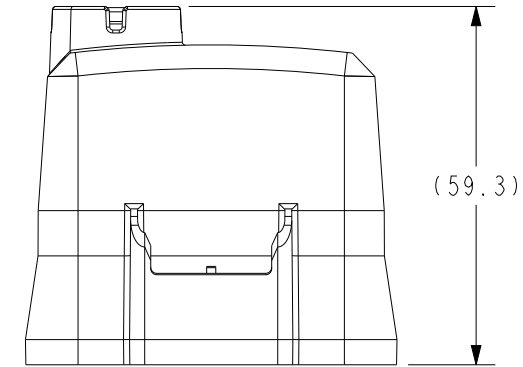
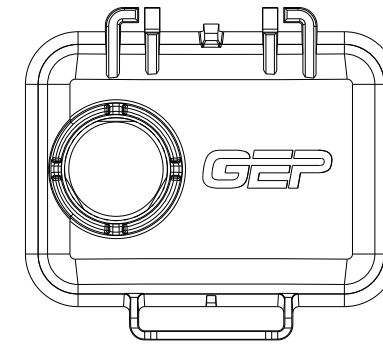

		16830 Pheasant Drive Brookfield, WI 53005		
PART NO:		FRH - MAXI ISO RELAY & MAXI FUSE SERIES (SALES)		
DESCRIPTION:		FRH - MAXI ISO RELAY AND MAXI FUSE SERIES DRAWING		
CUSTOMER:		STANDARD		
METRIC (MM)	REV	SHEET	SCALE	SIZE
	0	5 OF 8	1:1	B

# FRH - ACCESSORY OPTIONS

FOR NON-STANDARD MOUNTING OPTIONS EMAIL  
GEPENGINEERING@GEPPOWERPRODUCTS.COM TO REVIEW

FRH-A12-MB-A1  
BRACKET - PDM,FRH,FLAT WITH ANTI-ROTATION, ZINC STEEL

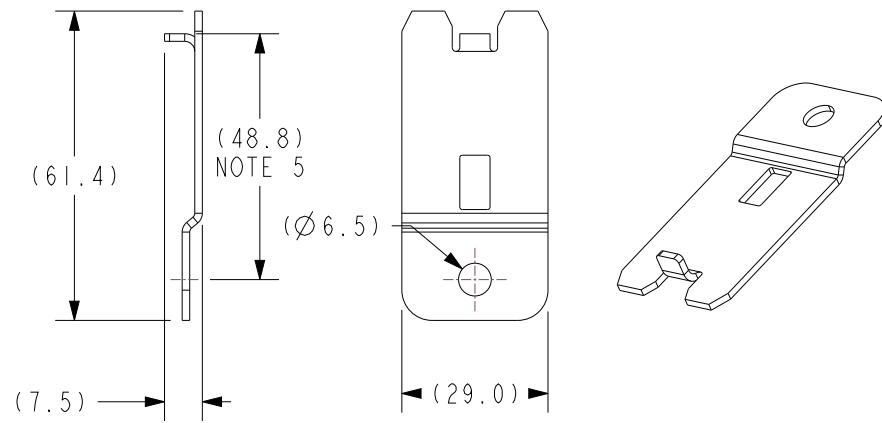

FRH-A12-MB-A2  
BRACKET - PDM, FRH, FLAT WITH ANTI-ROTATION, STAINLESS 304

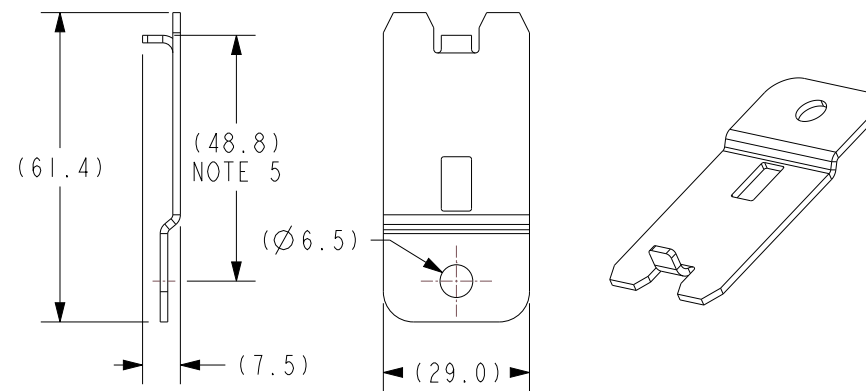

FRH-A12-MB-B1  
BRACKET - PDM, FRH, FLAT WITHOUT ANTI-ROTATION, ZINC STEEL

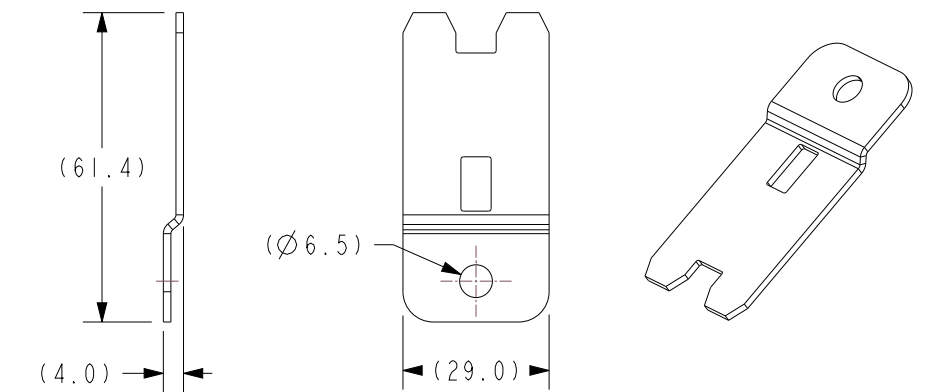

FRH-A12-MB-B2  
BRACKET - PDM, FRH, FLAT WITHOUT ANTI-ROTATION, STAINLESS 304

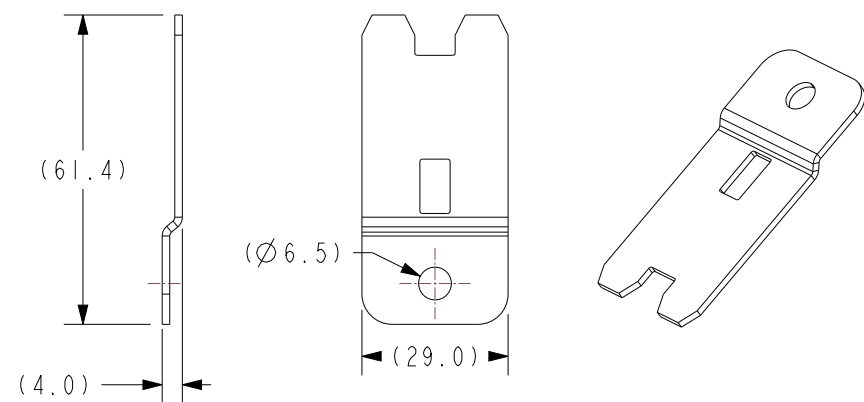

FRH-A12-MB-C1  
BRACKET - PDM, FRH, 90° BENT, ZINC STEEL

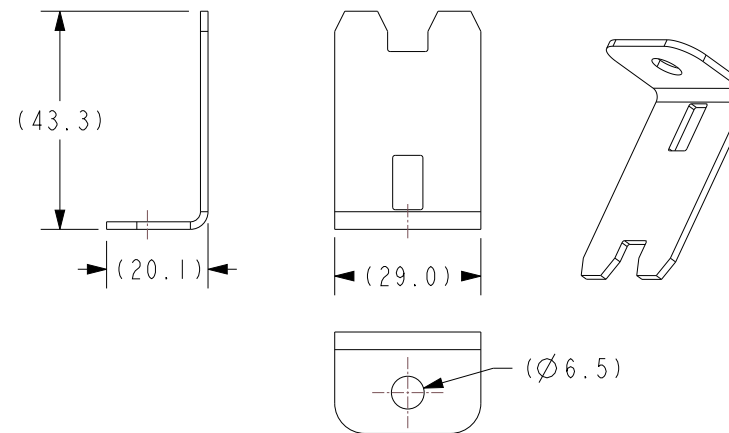

FRH-A12-MB-C2  
BRACKET - PDM, FRH, 90° BENT, STAINLESS 304

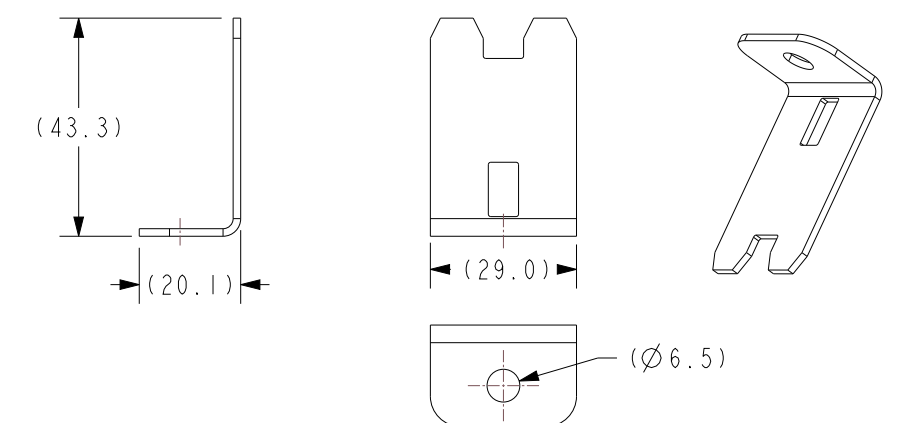

FRH-A-CPA  
CPA - PDM, FRH

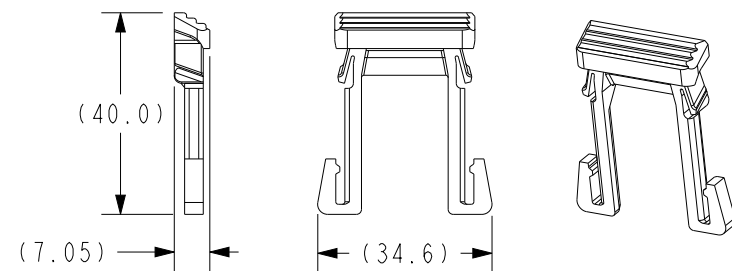

SC38-2015A-B003  
TPA - FRH - MAXI ISO RELAY AND MAXI FUSE - A SIDE

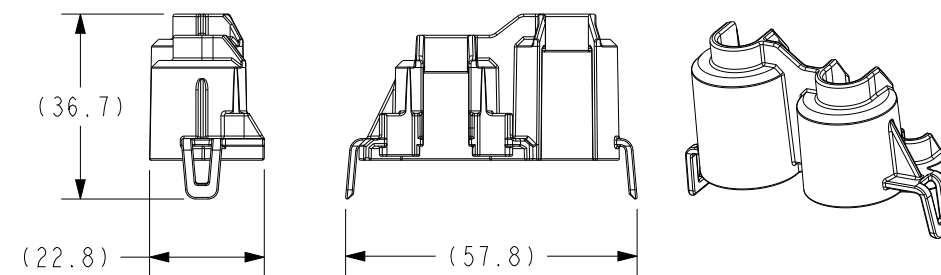

SCALE 1:1.5

SC38-2015B-B003  
TPA - FRH - MAXI ISO RELAY AND MAXI FUSE - B SIDE

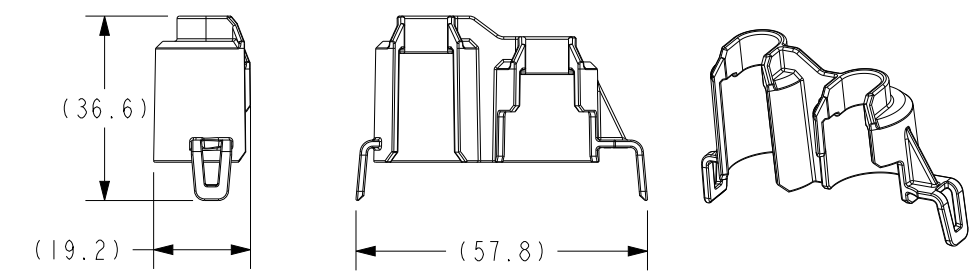

SCALE 1:1.5

<b>GEP</b> POWER PRODUCTS		16830 Pheasant Drive Brookfield, WI 53005		
PART NO:	FRH - MAXI ISO RELAY & MAXI FUSE SERIES (SALES)			
DESCRIPTION:	FRH - MAXI ISO RELAY AND MAXI FUSE SERIES DRAWING			
CUSTOMER:	STANDARD			
METRIC (MM)	REV 0	SHEET 6 OF 8	SCALE 1:1	SIZE B

# ACCESSORY ASSEMBLY INSTRUCTIONS

## TPA INSTALLATION

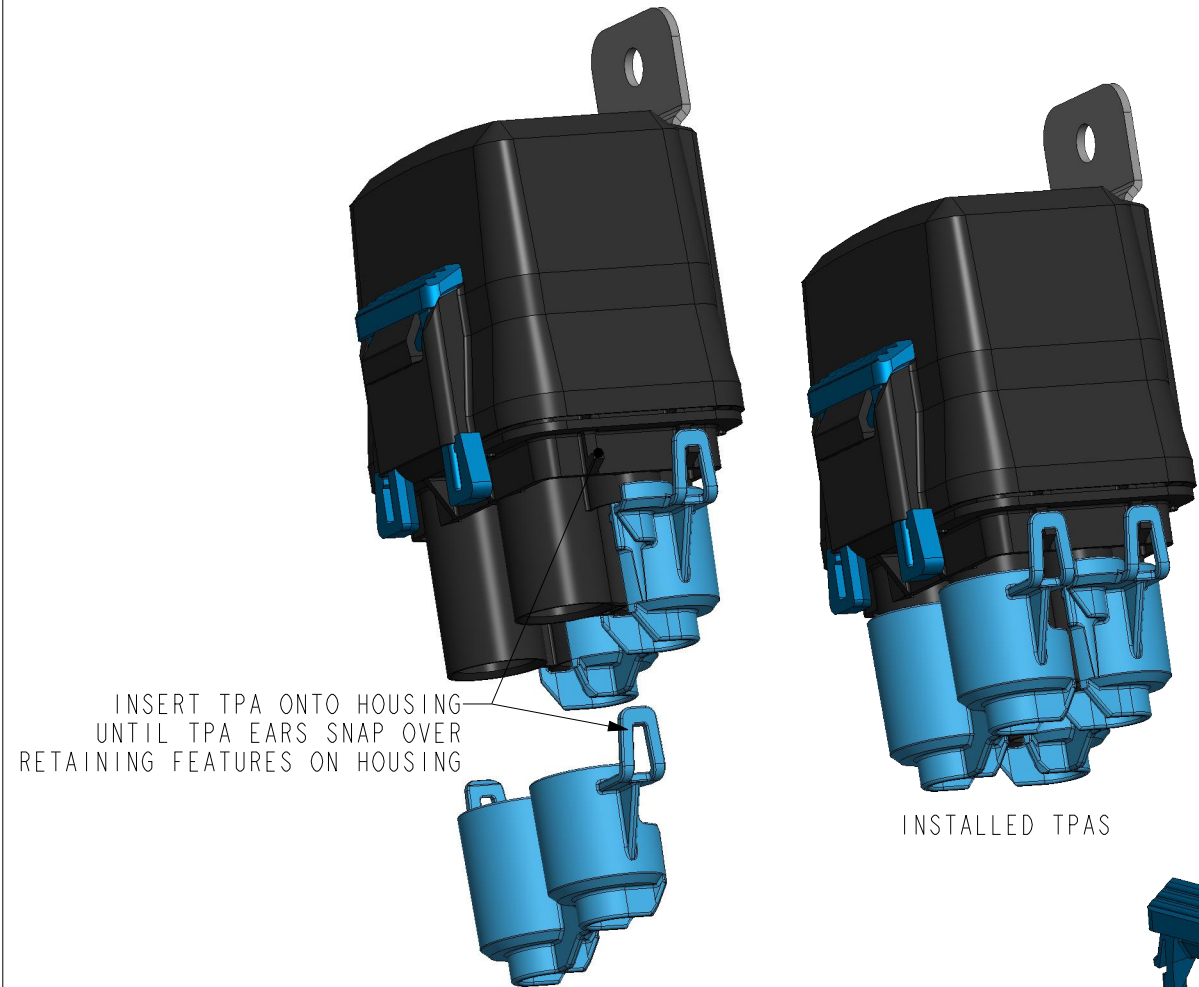

## MOUNTING BRACKET INSTALLATION

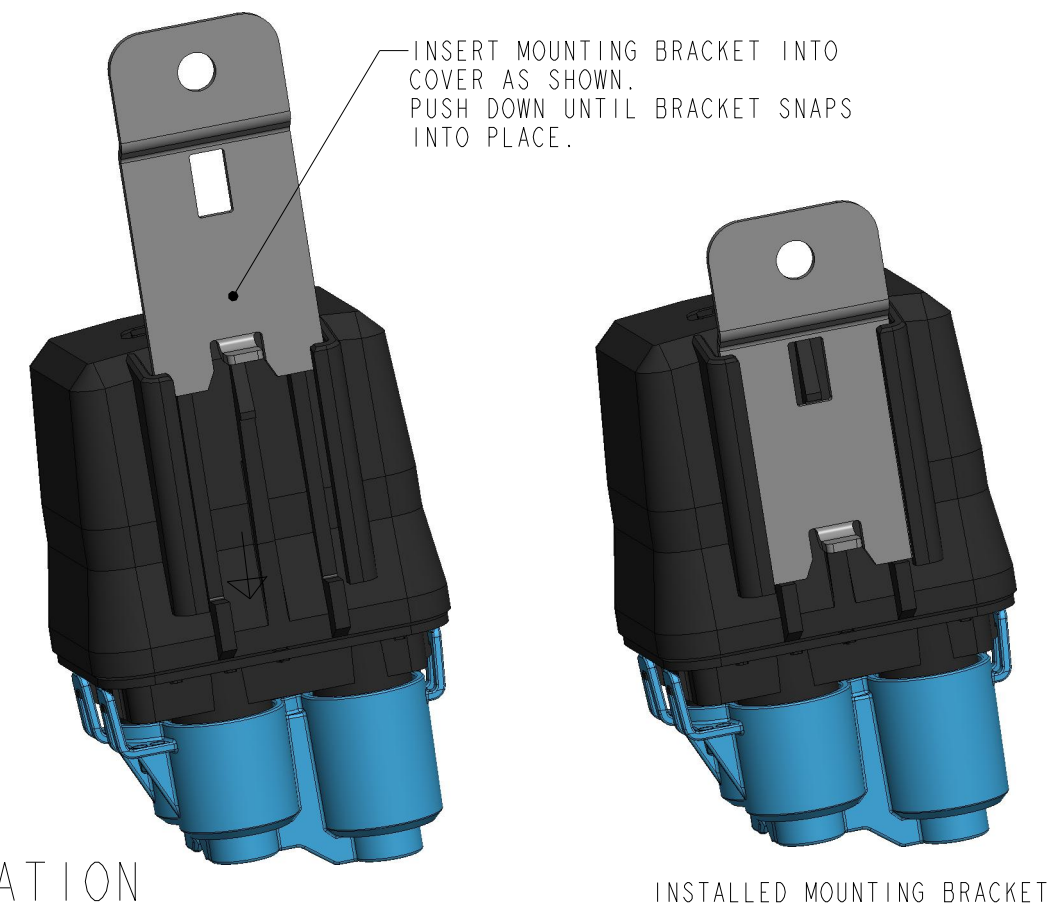

## CPA INSTALLATION

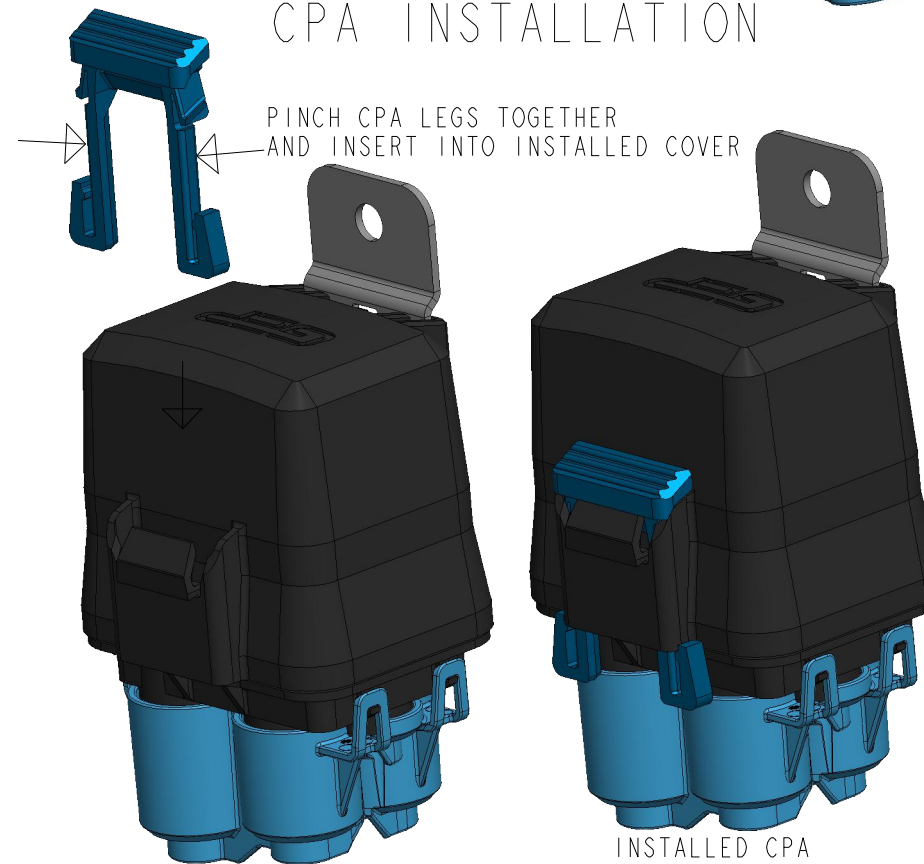

<b>GEP</b> POWER PRODUCTS		16830 Pheasant Drive Brookfield, WI 53005		
PART NO:	FRH - MAXI ISO RELAY & MAXI FUSE SERIES (SALES)			
DESCRIPTION:	FRH - MAXI ISO RELAY AND MAXI FUSE SERIES DRAWING			
CUSTOMER:	STANDARD			
METRIC (MM)	REV 0	SHEET 7 OF 8	SCALE 1:1.25	SIZE B

# DEPINNING INSTRUCTIONS

## LEAR MAK8 TERMINAL DEPINNING

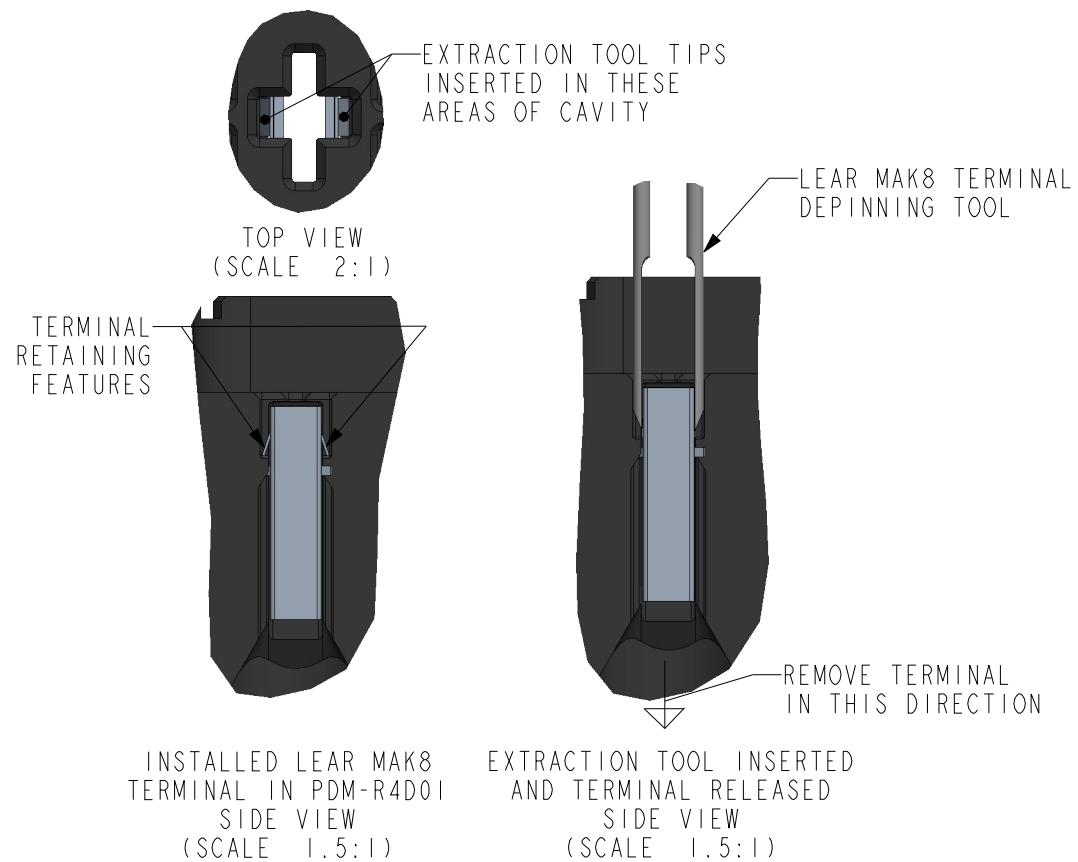

## 630 TERMINAL DEPINNING

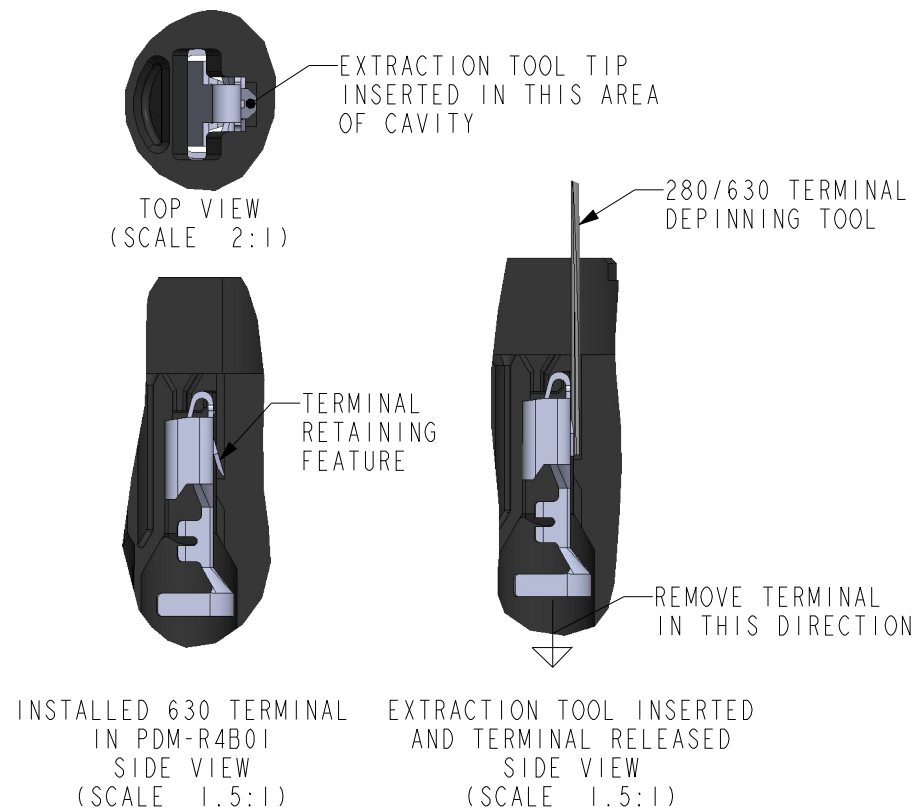

## DUCON 9.5 TERMINAL DEPINNING

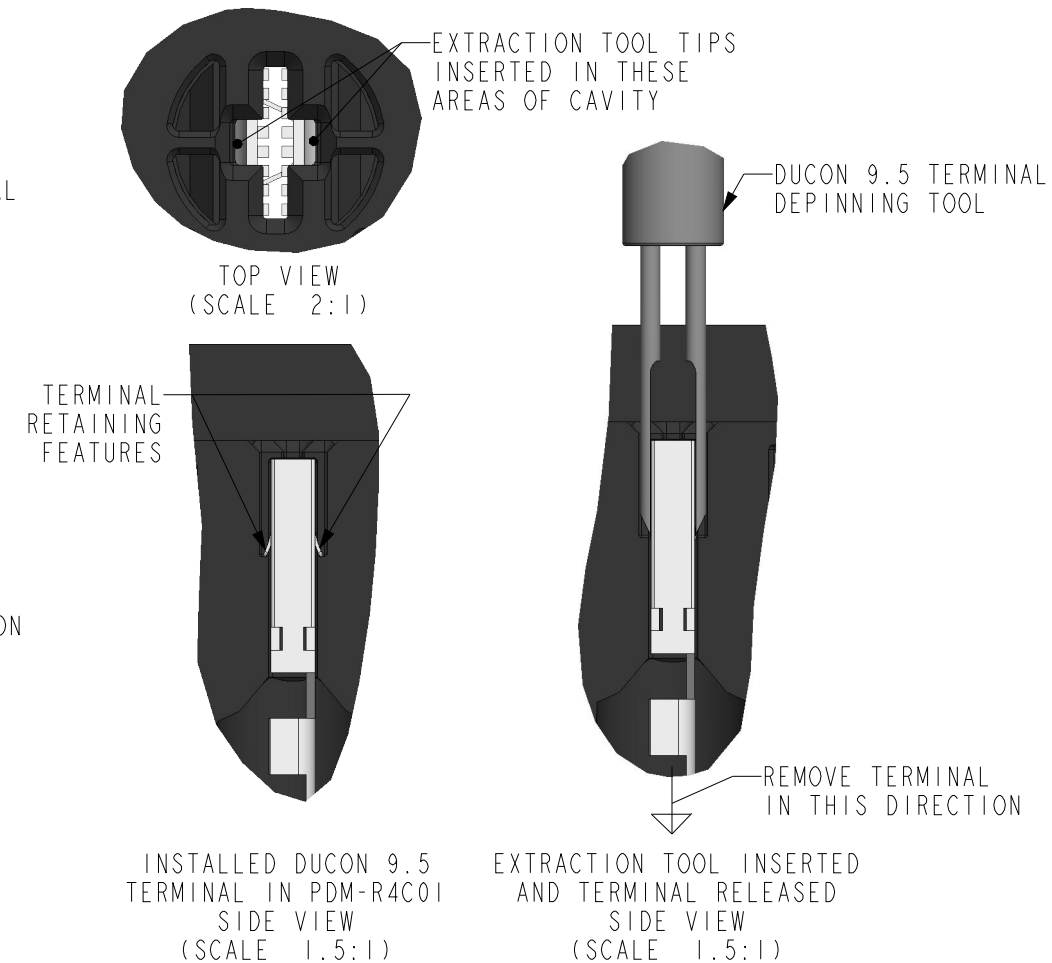

		16830 Pheasant Drive Brookfield, WI 53005		
PART NO:	FRH - MAXI ISO RELAY & MAXI FUSE SERIES (SALES)			
DESCRIPTION:	FRH - MAXI ISO RELAY AND MAXI FUSE SERIES DRAWING			
CUSTOMER:	STANDARD			
METRIC (MM)	REV 0	SHEET 8 OF 8	SCALE 1:1	SIZE B