

REV	REVISION DETAILS	ECO	DATE	BY	ABY
0	INITIAL RELEASE	NP-0660	27NOV2017	JWK	JML
1	UPDATED TO LATEST DRAWING STANDARDS. ADDED SC42-2018A-A001 AS HOUSING AND SEAL OPTION. ADDED SC19-2001A-A001, SC56-2000A-B001, SC55-2000A-A001 AS ACCESSORY OPTIONS. UPDATED PART NUMBER AND DESCRIPTION.	NP-005914	13FEB2024	JWK	JML
2	UPDATED NOTES	NP-006181	12JUN2024	JWK	JML
3	ADDED PLUG WITH SEAL TO ACCESSORIES. ADDED VENTED COVER OPTION. UPDATED LAYOUT OF ACCESSORIES AND MOUNTING BRACKET SHEETS. UPDATED TABLE A. UPDATED NOTES.	NP-007409	01MAY2026	JWK	JML

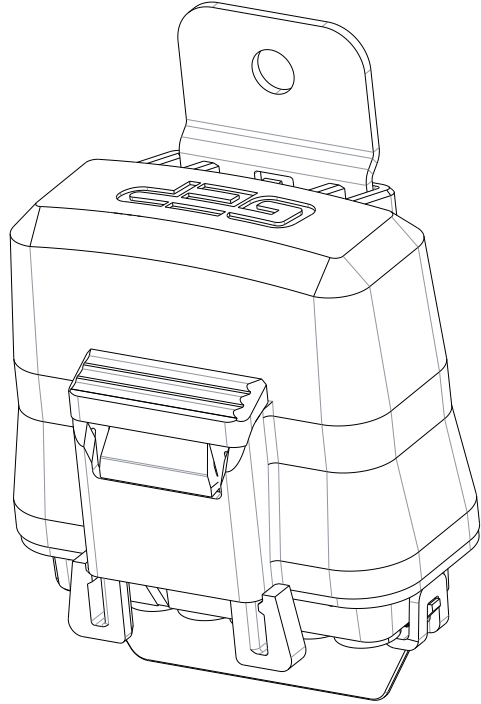

ISO VIEW
FOR REF ONLY

CONFIDENTIAL

The information contained in this document is the property of GEP Power Products. It is not for public disclosure. Possession of the information does not convey any right to loan, sell or disclose the information. Unauthorized reproduction or use of the information is prohibited. This document is to be returned to GEP Power Products upon completion of the purpose for which it is loaned or upon request.

<p>▲ CRITICAL DIMENSIONS ON FEATURES TO BE CHECKED DURING ANY SET-UP ADJUSTMENTS, TOOL CHANGES, OR ANNUAL MAINTENANCE ON TOOLING.</p>	<p>○ DIMENSIONS OR FEATURES TO BE CHECKED FROM RUN-TO-RUN</p>
<p>TOLERANCES UNLESS OTHERWISE SPECIFIED</p>	
<p>METRIC TOL</p>	<p>ENGLISH TOL</p>
<p>1 PL DEC. = ±.25 2 PL DEC. = ±.13</p>	<p>2 PL DEC. = ±.01 3 PL DEC. = ±.005</p>
<p>THIRD ANGLE PROJECTION</p>	
<p>ANGULAR TOL = ±2° FRACTION TOL = ±1/64 IN</p>	
<p>DIMENSIONS INSIDE PARENTHESES OR CONTAINING "REF" ARE FOR REFERENCE ONLY.</p>	
<p>COPYRIGHT - GEP POWER PRODUCTS This is unpublished work. The disclosure of this work is limited to a select personnel. Further dissemination or disclosure to the public is PROHIBITED. This unpublished work is protected by Federal Copyright law and all rights thereunder are reserved by GEP Power Products.</p>	

GEP POWER PRODUCTS		16830 Pheasant Drive Brookfield, WI 53005		
PART NO:		FRH-A12 PDM SERIES (SALES)		
DESCRIPTION:		FRH-A12 PDM SERIES (SALES)		
CUSTOMER:		STANDARD		
METRIC (MM)	REV	SHEET	SCALE	SIZE
	3	1 OF 7	1:1	B

EXAMPLE CONFIGURATION & NOTES

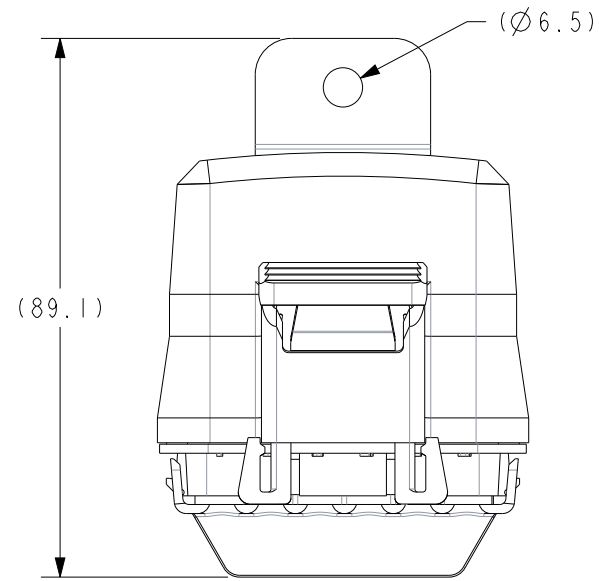
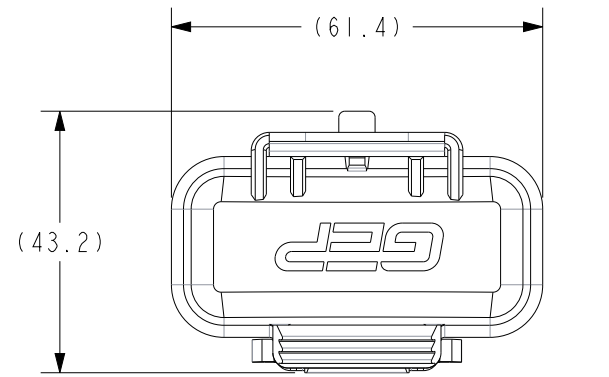

EXAMPLE CONFIGURATION WITH DIMENSIONAL INFO

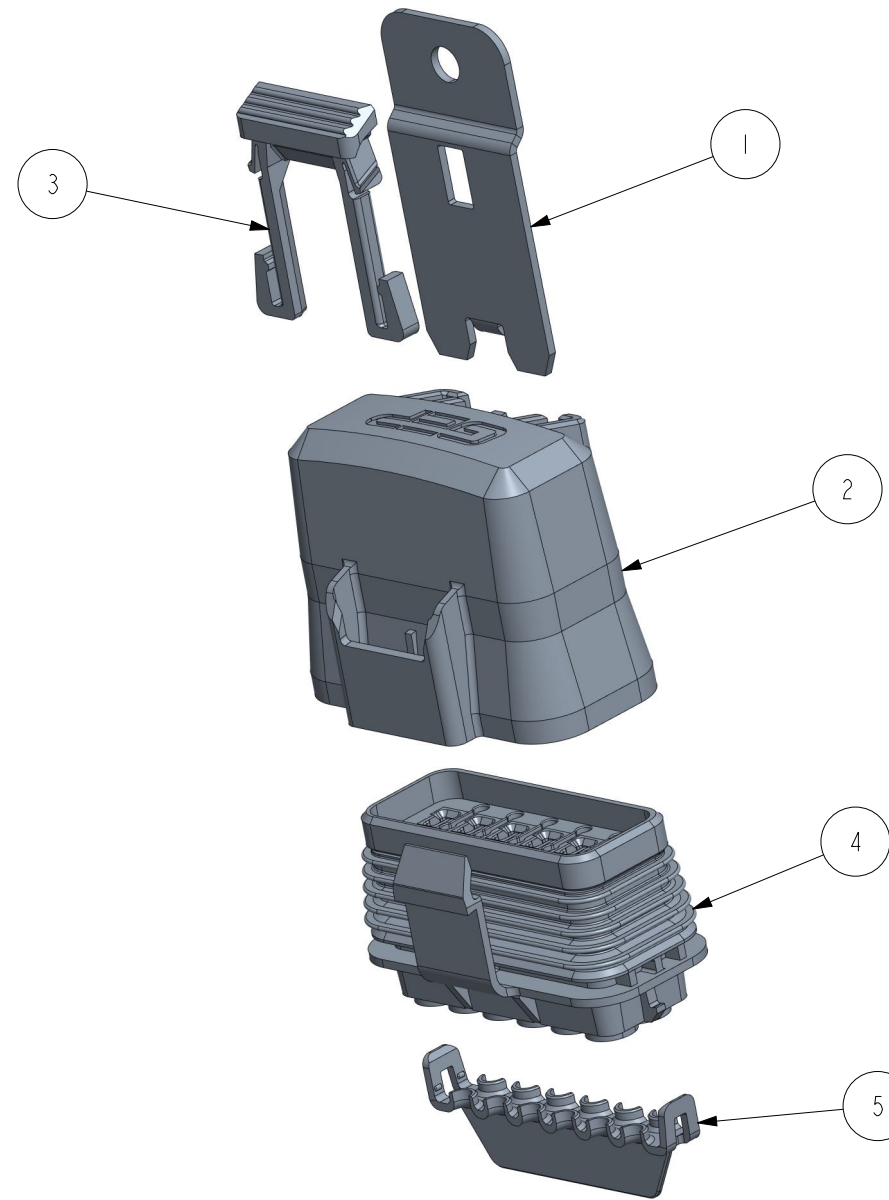

EXAMPLE CONFIGURATION EXPLODE VIEW

- NOTES:
1. BASE, COVER, & CPA MATERIAL: UNFILLED PBT
 2. TPA & DIODE KEY MATERIAL: NYLON
 3. COLORS: HOUSING, COVER - BLACK
SEAL - BLUE (OR RED IF MANUFACTURED BEFORE AUGUST 2026)
TPA, CPA - BLUE
 4. BRACKET MATERIAL: ZINC PLATED STEEL OR STAINLESS STEEL (SEE PART DESCRIPTION)
 5. DESIGNED TO USE DELPHI 280 METRI-PACK TERMINALS AND SEALS (SEE TABLE A)
 6. RoHS AND REACH COMPLIANT

EXAMPLE ASSEMBLY BOM			
ITEM	DESCRIPTION	PART NO.	QTY
1	BRACKET - PDM - FRH - FLAT WITH ANTI-ROTATION - ZINC STEEL	FRH-A12-MB-A1	1
2	COVER - PDM, FRH, 12 POS, GEP	FRH-A12-C	1
3	CPA - PDM - FRH	FRH-A-CPA	1
4	HOUSING AND SEAL - PDM, FRH, 12 POS	FRH-A12	1
5	TPA - PDM, FRH	FRH-A12-T	1

GEP POWER PRODUCTS 16830 Pheasant Drive Brookfield, WI 53005

PART NO: FRH-A12 PDM SERIES (SALES)

DESCRIPTION: FRH-A12 PDM SERIES (SALES)

CUSTOMER: STANDARD

METRIC (MM)	REV 3	SHEET 2 OF 7	SCALE 1:1.25	SIZE B
-------------	-------	--------------	--------------	--------

HOUSING W/SEAL OPTIONS

FRH-A12
HOUSING AND SEAL - PDM, FRH 12 POS
(FOR TERMINALS AND SEALS
SEE TABLE A)

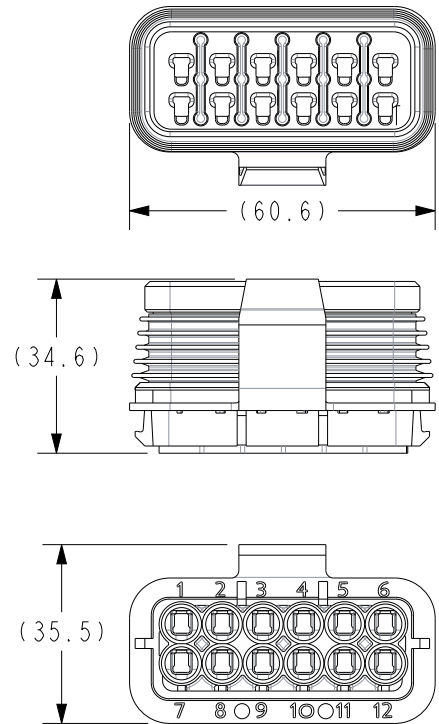

FRH-A12 EXAMPLE
POPULATED WITH FUSES/RELAY



SC42-2018A-A001
HOUSING AND SEAL - PDM
FRH 12 POS - ROTATED FUSE
(FOR TERMINALS AND SEALS
SEE TABLE A)

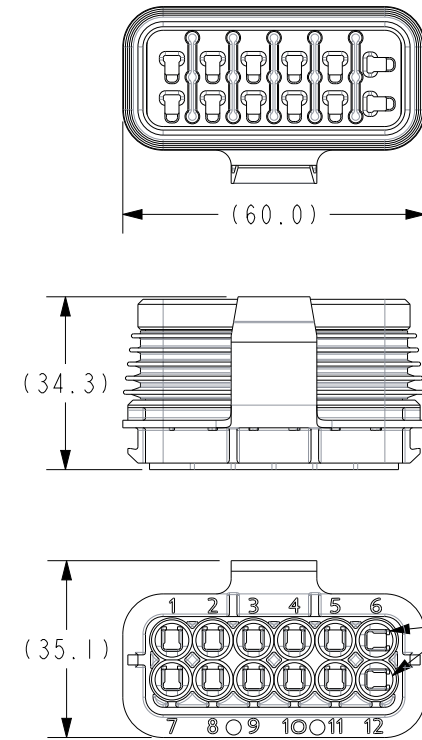

SC42-2018A-A001 EXAMPLE
POPULATED WITH FUSES/RELAY



NOTE: POSITIONS 6 AND 12
ARE ROTATED

		16830 Pheasant Drive Brookfield, WI 53005		
PART NO:	FRH-A12 PDM SERIES (SALES)			
DESCRIPTION:	FRH-A12 PDM SERIES (SALES)			
CUSTOMER:	STANDARD			
METRIC (MM)	REV 3	SHEET 3 OF 7	SCALE 1:1.5	SIZE B

HOUSING TERMINALS AND SEALS

FRH-A12
HOUSING AND SEAL - PDM, FRH 12 POS

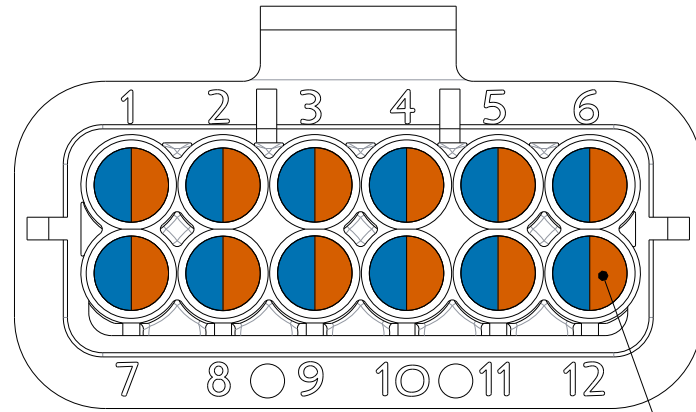

280 CAVITIES
SEE TABLE A FOR TERMINALS
AND CABLE SEALS

SC42-2018A-A001
HOUSING AND SEAL - PDM
FRH 12 POS - ROTATED FUSE

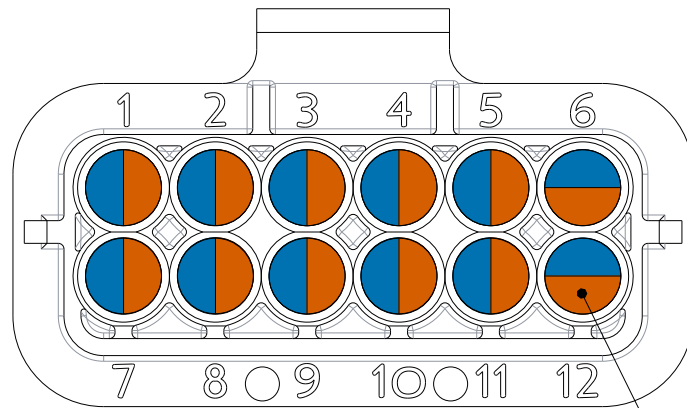

280 CAVITIES
SEE TABLE A FOR TERMINALS
AND CABLE SEALS

Table A			REV 2
APTIV (DELPHI) 280 METRI-PACK TERMINALS			
PART NUMBER	CABLE RANGE (mm ²)	MATERIAL	PLATING
12077413	3	TIN BRASS	TIN
12129493	2.0-3.0	TIN BRASS	TIN
12077411	0.8-1.0	TIN BRASS	TIN
12084201	0.35-0.50	TIN BRASS	TIN
12176387	5	BERYLLIUM COPPER	SILVER/NICKEL
12176388	2.0-3.0	BERYLLIUM COPPER	SILVER/NICKEL
12176389	0.8-1.0	BERYLLIUM COPPER	SILVER/NICKEL
APTIV (DELPHI) 280 METRI-PACK CABLE SEALS (FOR REF. ONLY)			
PART NUMBER	CABLE DIAMETER	MATERIAL	COLOR
15324981	3.45-4.3	SILICONE	BLUE
15324980	2.81-3.49	SILICONE	LT. GRAY
15324982	2.03-2.85	SILICONE	GREEN
15324984	2.03-2.42	SILICONE	TAN
15324985	1.6-2.15	SILICONE	PURPLE
15324983	1.29-1.70	SILICONE	DK. RED
12010300	PLUG	SILICONE	GREEN
DELPHI 280 METRI-PACK TERMINAL REMOVAL TOOL (FOR REF. ONLY)			
PART # 12094430			

GEP POWER PRODUCTS 16830 Pheasant Drive
Brookfield, WI 53005

PART NO: FRH-A12 PDM SERIES (SALES)
DESCRIPTION: FRH-A12 PDM SERIES (SALES)
CUSTOMER: STANDARD

METRIC (MM)	REV 3	SHEET 4 OF 7	SCALE 1:1	SIZE B
-------------	----------	-----------------	--------------	-----------

COVER & ACCESSORY OPTIONS

FRH-A12-C
COVER - PDM, FRH, 12 POS, GEP

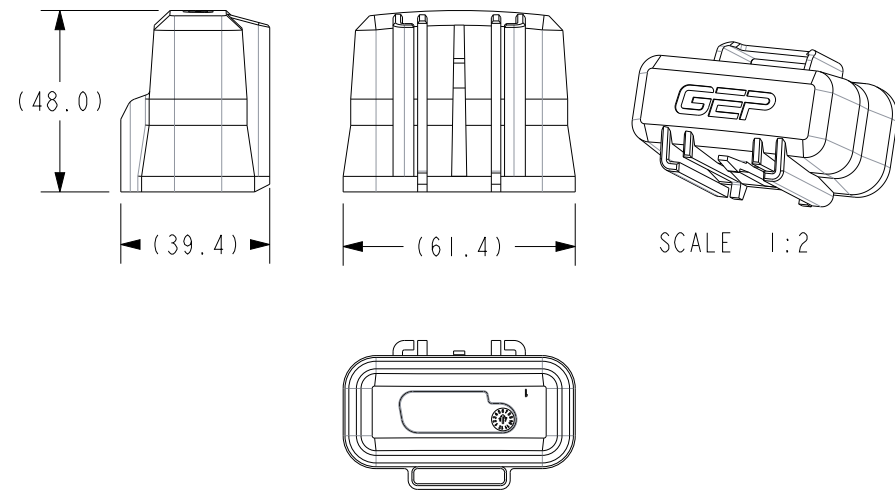

FRH-A12-CB-1
COVER - PDM, FRH 12 POS, SINGLE SIDE MOUNT, PLAIN

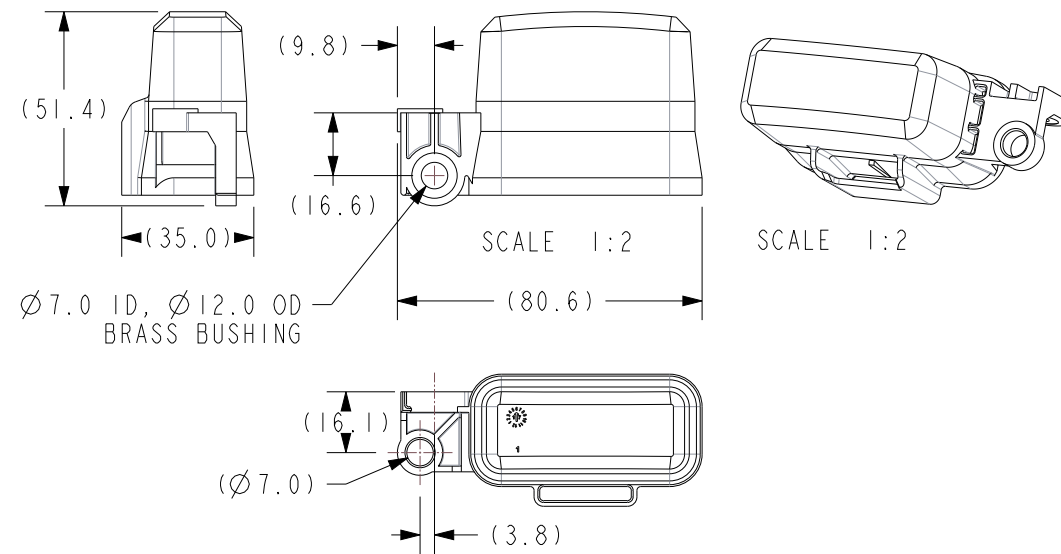

FRH-A12-CD-1
COVER - PDM, FRH 12 POS, DOUBLE SIDE MOUNT, PLAIN

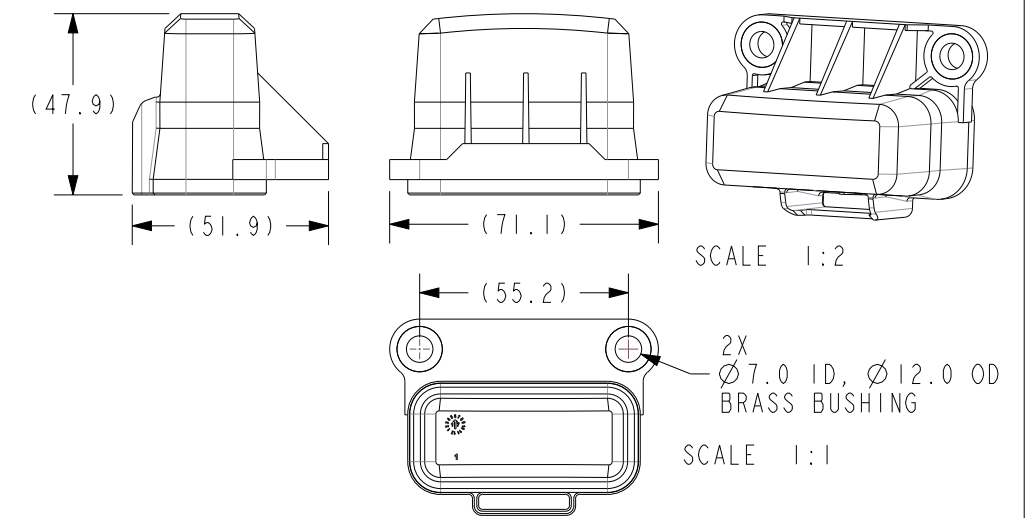

SC42-2027A-A001
COVER WITH VENT - FRH - A12

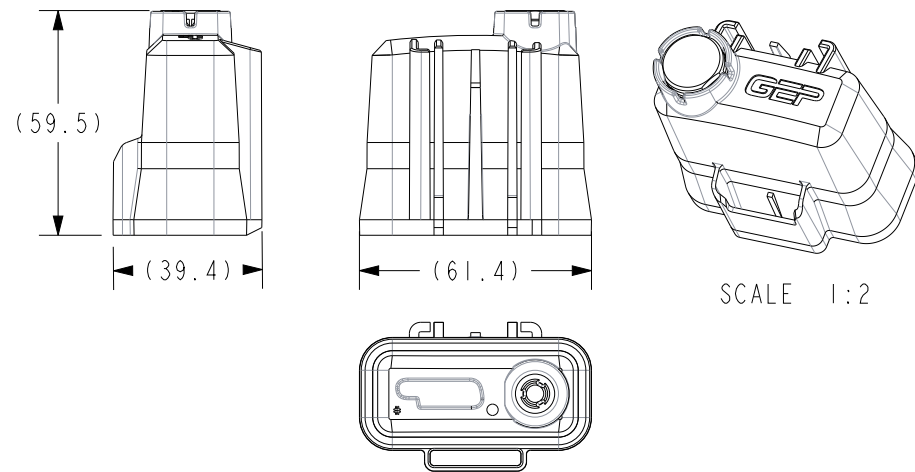

FRH-A12-T
TPA - PDM, FRH

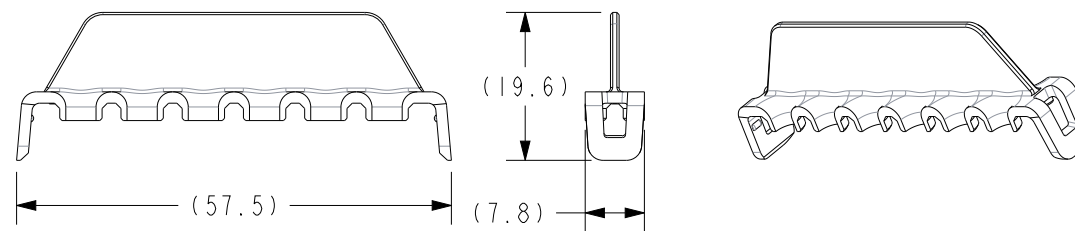

FRH-A-CPA
CPA - PDM, FRH

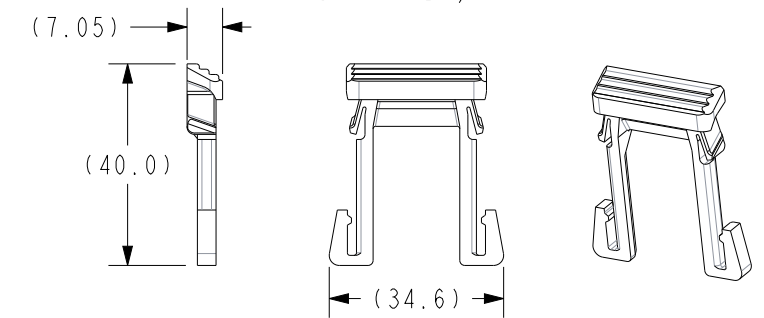

PDM-TK
DIODE KEY

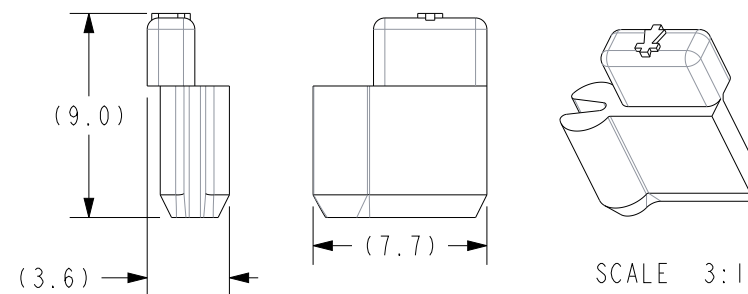

SC55-2000A-A001
PLUG AND SEAL - PDM
CAVITY PLUG - METRIPACK 280

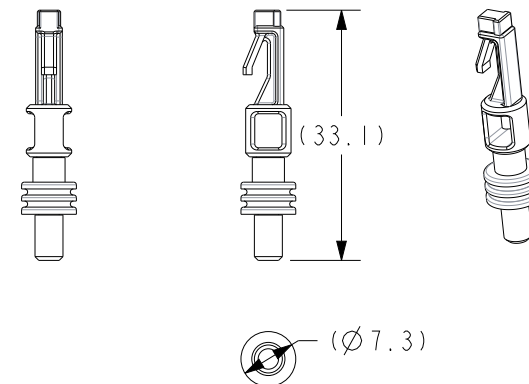

GEP POWER PRODUCTS		16830 Pheasant Drive Brookfield, WI 53005		
PART NO:	FRH-A12 PDM SERIES (SALES)			
DESCRIPTION:	FRH-A12 PDM SERIES (SALES)			
CUSTOMER:	STANDARD			
METRIC (MM)	REV 3	SHEET 5 OF 7	SCALE 1:1	SIZE B

MOUNTING BRACKET OPTIONS

FOR NON-STANDARD MOUNTING OPTIONS EMAIL
GEPENGINEERING@GEPPOWERPRODUCTS.COM TO REVIEW

FRH-A12-MB-A1
BRACKET - PDM,FRH,FLAT WITH ANTI-ROTATION, ZINC STEEL

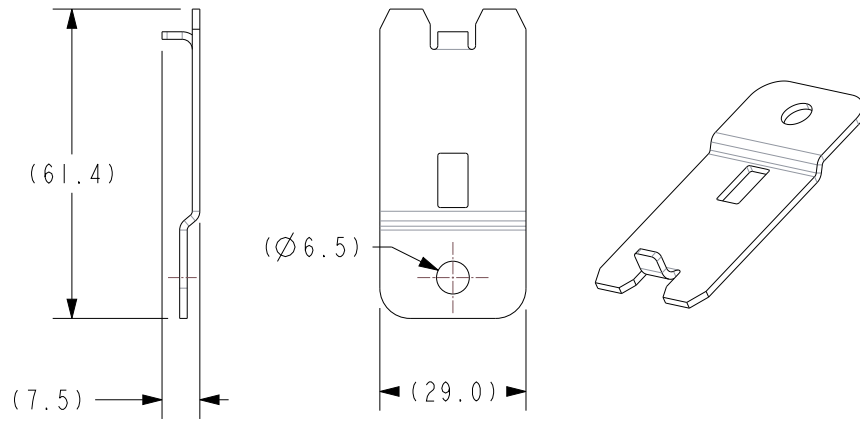

FRH-A12-MB-A2
BRACKET - PDM, FRH, FLAT WITH ANTI-ROTATION, STAINLESS 304

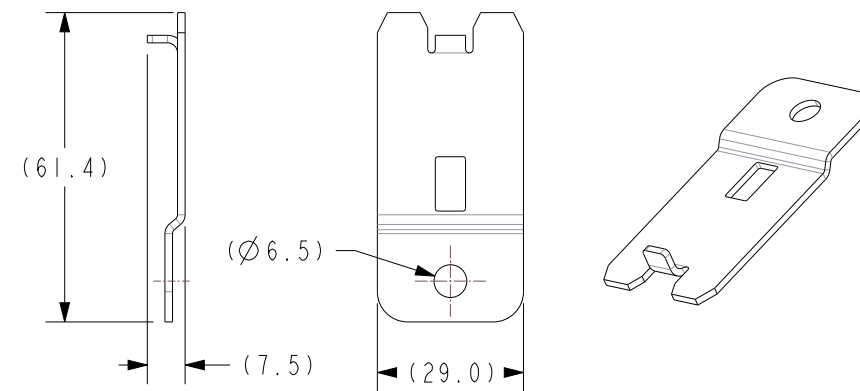

FRH-A12-MB-B1
BRACKET - PDM, FRH, FLAT WITHOUT ANTI-ROTATION, ZINC STEEL

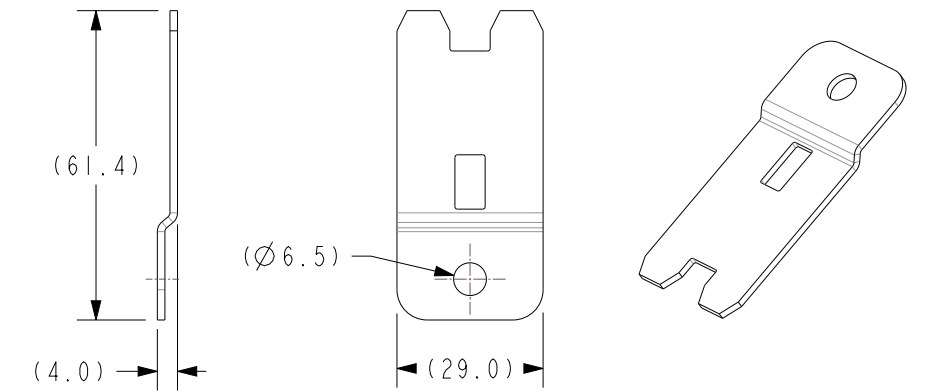

FRH-A12-MB-B2
BRACKET - PDM, FRH, FLAT WITHOUT ANTI-ROTATION, STAINLESS 304

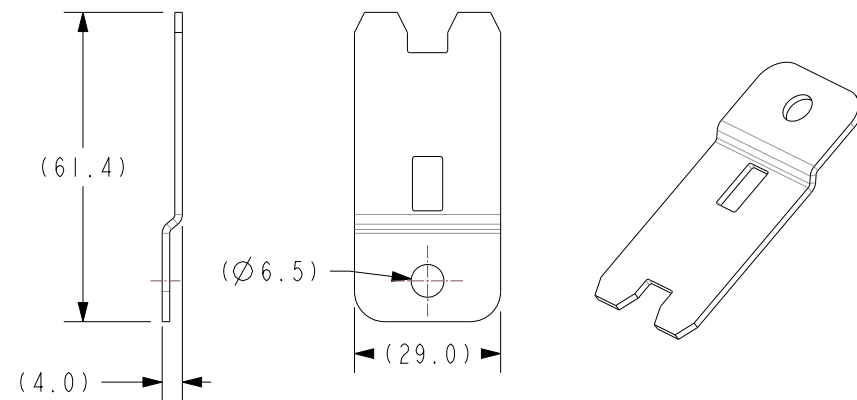

FRH-A12-MB-C1
BRACKET - PDM, FRH, 90° BENT, ZINC STEEL

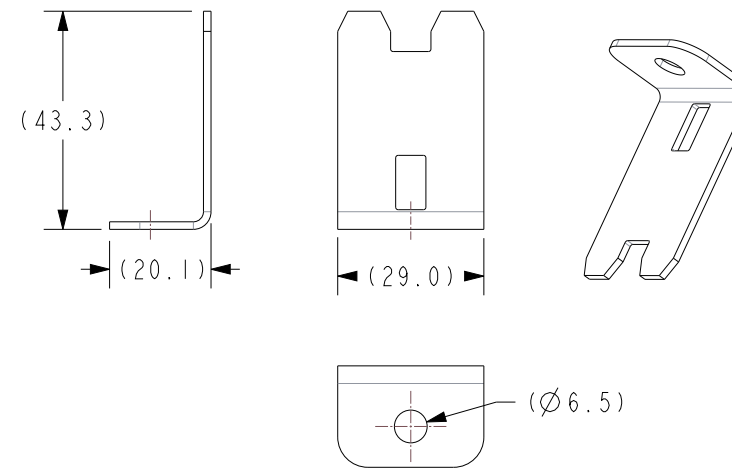

FRH-A12-MB-C2
BRACKET - PDM, FRH, 90° BENT, STAINLESS 304

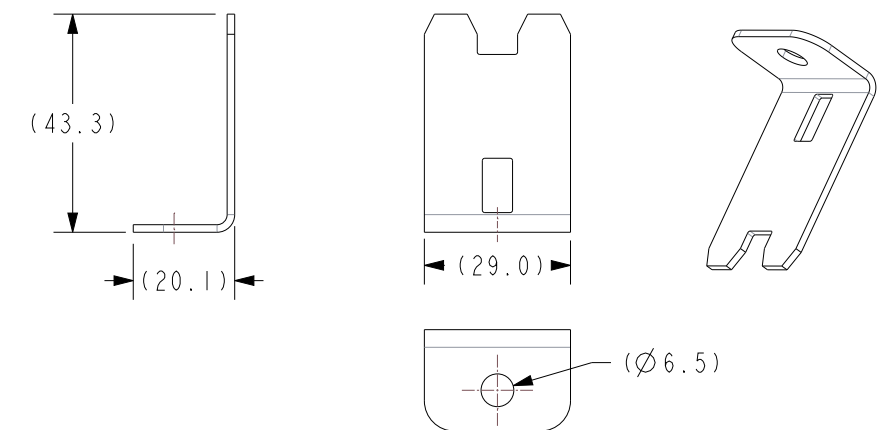

GEP POWER PRODUCTS		16830 Pheasant Drive Brookfield, WI 53005		
PART NO:	FRH-A12 PDM SERIES (SALES)			
DESCRIPTION:	FRH-A12 PDM SERIES (SALES)			
CUSTOMER:	STANDARD			
METRIC (MM)	REV 3	SHEET 6 OF 7	SCALE 1:1.5	SIZE B

DEPINNING INSTRUCTIONS

280 TERMINAL DEPINNING

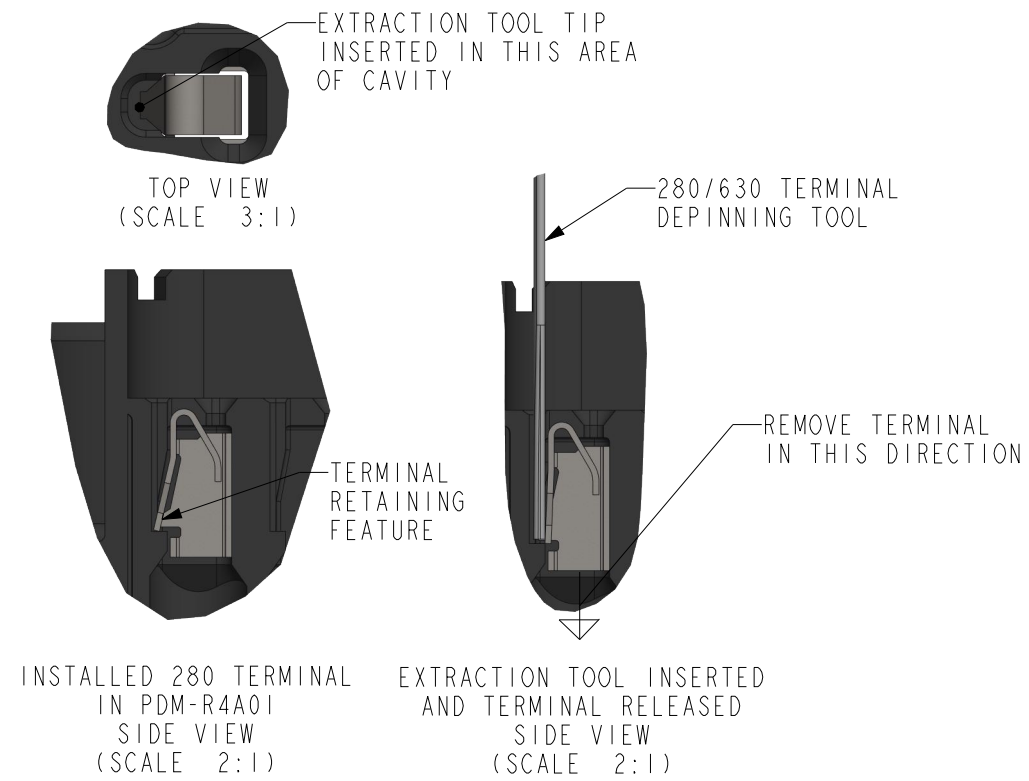

		16830 Pheasant Drive Brookfield, WI 53005		
PART NO:	FRH-A12 PDM SERIES (SALES)			
DESCRIPTION:	FRH-A12 PDM SERIES (SALES)			
CUSTOMER:	STANDARD			
METRIC (MM)	REV 3	SHEET 7 OF 7	SCALE 1:1	SIZE B